

How to fit and operate your Roman blind (Deluxe)

Web-Blinds

• WE MAKE IT, YOU FIT IT •

You should have:

First check you've got all the fittings that come with your blind.

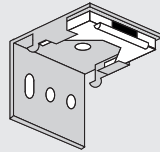

Brackets:
quantity to suit
length of blind

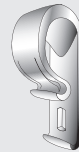

Safety hook:
x 1 chain operated

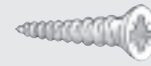

Wood screws:
x 4

Standard fixings for the most common installations supplied

Getting started

YOU WILL NEED:

- A drill with correct bit
- A crossheaded screwdriver
- A metal tape measure
- A pencil

- Your brackets are packed separately in the box. Please ensure you've located them before disposing of the packaging.
- The brackets are a universal type that can be used to top fix the blind into a recess or face fix into a frame or a wall.
- Please read the following instructions carefully before you start fitting your blind.

1

To fix the brackets

1. Locate the measuring points you used to calculate the width of the blind. You may be able to use the blind as a template.
2. Ensure the brackets are positioned a suitable distance away from any window handles or obstructions to allow the blind to operate smoothly.
3. Ideally, position the brackets 5cm in from each end of the head rail. Any additional brackets supplied should be fitted centrally.
4. Hold a bracket in position and mark where the screws will go, using the relevant holes in the bracket as a guide.
5. If you're fitting to a wall or lintel, use a drill with the suitable sized bit to make your holes, and push in wallplugs.
6. If you're fitting into a wooden frame, screw your brackets into position. You may want to make pilot holes to allow easier fixing of the screws.
7. Fix the bracket into place and repeat on the other side of the blind.

2

To fix the blind

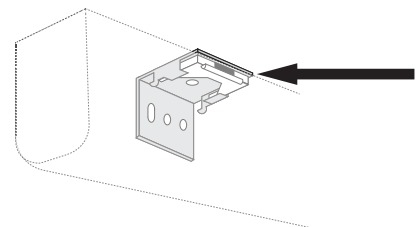

1. Hold the rail at a slight angle and locate the front lip of the rail onto the plastic lip of the bracket

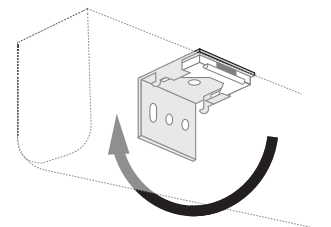

2. Gently push the back of the rail up towards the back of the bracket, while straightening the angle of the rail to lock it into place

To remove the rail, simply push the rail back towards the back of the bracket and twist the back of the rail downwards, it will disengage the hooks at the back of the bracket and allow the blind to be taken down

3

To operate your blind

Pull down on the rear part of the chain to raise the blind

Pull down on the front part of the chain to lower the blind

Even though the chain is a continuous loop, if you inadvertently pull the chain in the wrong direction, the blind will raise at an uneven angle. To rectify this lower the blind fully and then simply use the rear chain to raise the blind and level it again

Do not untie the cords at the back of the blind to adjust the level, only use the chain

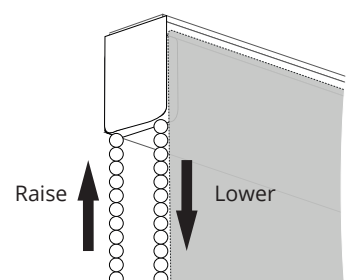

continued overleaf ▶

Safety tips:

There are things that you can do to reduce risk in your home.

- Move beds, cots and furniture away from the window.
- Do not let cords or chains hang loose. Make sure they are kept out of reach of children at all times.
- Do not tie loose cords and chains together.
- Check the condition of all safety devices if not used regularly and replace if the device is faulty.

How to fit and use your Child Safety Devices

4

Warning

Blinds can be potentially dangerous to small children. Please be aware that swallowing small parts can cause internal asphyxiation. Looped or low hanging cords, chains or tapes can create hazardous loops which could lead to the risk of strangulation. We do everything we can to ensure your chosen product is child safe. As a minimum all of our blinds meet the European Standard BS EN 13120 for safety. Our instructions and the supplied Child Safety device(s) are intended for you to ensure that your blind is as safe as possible.

The information below gives guidance for fitting the provided child safety devices. All safety devices must be correctly installed for the protection from strangulation of young children and the proper use of the blind. Please read the instructions carefully and keep safe for future reference.

5

To reconnect the inner cord breakaway clip

1. The inner cord breakaway clip is attached to the cord and the tape on the reverse of the blind. The clip will break away in two parts if any reasonable weight is placed between the cord and the back of the blind.

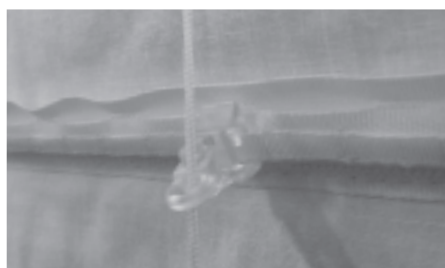

fig 1

2. One inner cord breakaway clip will be used on each cord where it crosses a tape. See fig. 1



fig 2

3. If the clip breaks apart, push the small c-clip section (which will remain on the cord) onto the front of the post part (which will remain on the tape). See fig. 2

6

Fitting the safety hook

1. Put the control chain into the hook at the maximum distance from the control mechanism. Ensure that the chain is taut and that the hook is at the bottom of the loop.
2. Screw the hook to a wall adjacent to the blind. If the hook has a slot, ensure the screw is placed at the bottom of the slot and that the chain is taut before screwing in place. This will prevent the hook from moving up and down during operation and ensure that the correct tension is maintained. See fig. 1.



fig 1